

NO.	DESCRIPTION	DWG. NO.	MATERIAL	Q'TY	FINISH/SIZE	NOTE

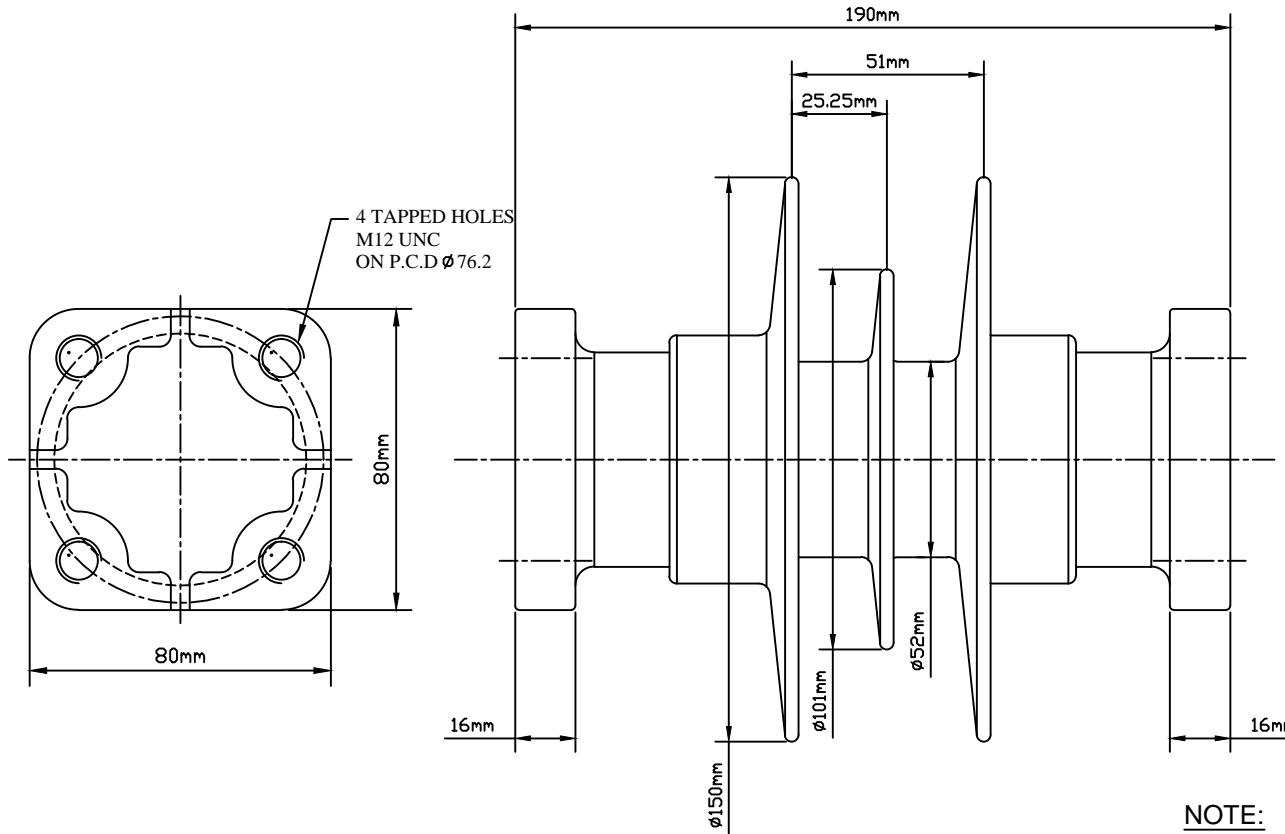

<u>DIMENSIONS</u>	
LEAKAGE DISTANCE	300 mm
DRY ARCING DISTANCE	150 mm
<u>MECHANICAL VALUES</u>	
SPECIFIED CANTILEVER LOAD	12.5 kN
Max. DESIGN CANTILEVER LOAD	6.00 kN
<u>ELECTRICAL VALUES</u>	
Low-Freq. WITHSTAND-WET	30 kV
IMPULSE FLASHOVER-POS	105 kV
IMPULSE FLASHOVER-NEG	115 kV
IMPULSE WITHSTAND-POS	95 kV
IMPULSE WITHSTAND-NEG	105 kV
<u>RADIO INFLUENCE VOLTAGE DATA</u>	
60 Hz TEST VOLTAGE	5 kV
MAXIMUM RIV @ 1,000kHz	50 uV
<u>PACKING INFORMATION</u>	
NET WEIGHT EACH	2.7 kg
PACKED WEIGHT EACH	3.2 kg
NO. IN STANDARD PACKAGE	6 PCS

**NOTE:**

1. END FITTING ARE MADE FROM SPHEROIDAL GRAPHITE CAST IRON.
2. FIBERGLASS ROD ARE MADE FROM EPOXY RESIN.
3. END FITTING HAVE TAPPED HOLES WITH M12 UNC ON  $\phi 76.2$  B.C.
4. THE DIA. OF FRP ROD IS  $\phi 45$ mm SOLID.
5. THE TOLERANCE ON ALL DIMENSIONS SHALL BE AS FOLLOWS:  
 $\pm(0.04d+1.5)$ mm when  $d < 300$ mm  
 $\pm(0.025d+6)$ mm when  $d > 300$ mm with a maximum of 50mm

NO.	DATE	REVISIONS	DESIGNED	APPROVED	REMARKS	DRAWN BY	DESIGNED BY	CHECKED BY	APPROVED BY	SCALE	DATE	NAME	REF. NO.	SHEET NO
3						J.H.PARK			C.H.PARK	1/1			POLYMER LINE POST INSULATOR 7.5kV Staion Post Insulator TR202	
2						OCT.12.2017			OCT.12.2017	1/1				
1/R	10/12/2017	INITIAL RELEASE	J.H.PARK	C.H.PARK								REF. NO.		SHEET NO
NO.	DATE	REVISIONS	DESIGNED	APPROVED	REMARKS							DWG.NO.	SPB008-TR202-M3	