

OPERATION MODE VIA OPERATING HANDLE :  
PULL DOWN R.H. (RED) END TO CLOSE  
PULL DOWN L.H. (GREEN) END TO OPEN  
(Always confirm status via CONTACT POSITION POINTER (4))

OPTIONAL LOCK for 2 stage operation - shown in "locked" position.  
To LOCK/UNLOCK engage operating stick Lift & Rotate 90°.  
When LOCKED end of bar shows RED.  
OPTIONAL: LOCKING KIT = 91777

RED FLAG LOW PRESSURE INDICATOR (6)

- NOTES :
- ① STAINLESS STEEL SWITCH ENCLOSURE PAINTED GREY.
  - ② PORCELAIN INSULATOR BUSHINGS ARE GLAZED LIGHT GREY.
  - ③ SUITABLE CROSSARM SIZE IS 109 max. WIDE x 50-135 max. HIGH.
  - ④ Switch Status POINTER [ ] (RED) = CLOSED, 0 (GREEN) = OPEN] DIRECTLY DRIVEN FROM INTERNAL CONTACTS.
  - ⑤ HANDLE LOCKOUT AUTOMATICALLY OPERATES WHEN GAS PRESSURE IS LOW - IN ADDITION :
  - ⑥ LOW GAS PRESSURE INDICATOR IS INCORPORATED.
  - ⑦ SAFETY GAS PRESSURE RELIEF DEVICE IS INCORPORATED.
  - ⑧ TERMINAL PALM DRILLED TO AS2395 No. 3
  - ⑨ TERMINAL COVER - MATERIAL : EPDM.

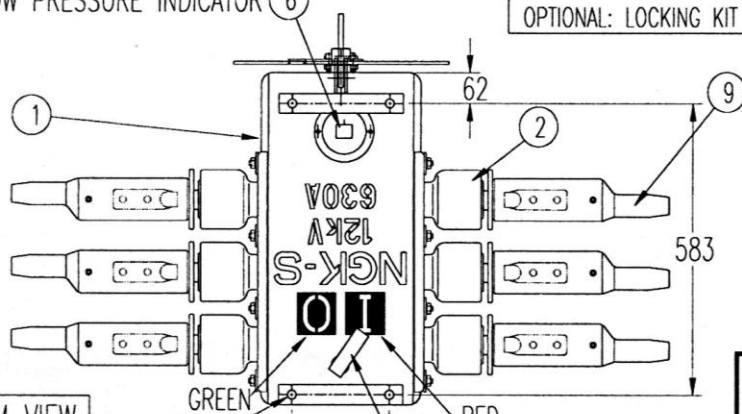

BOTTOM VIEW

SWITCH SHOWN IN CLOSED [ ] (RED)] POSITION

Rated Voltage	Ur 12kV	Rated Making Current (peak)	41.6kA
Rated Lightning Impulse W/stand	Up 95kVp	Insulator Bushing Creepage	417mm
Rated Frequency	fr 50Hz	Packing data - Switch in crate :	0.99m Wx0.69m Hx1.29m L = 0.88 m <sup>3</sup>
Rated Normal Current	Ir 630A	GROSS wt =	90 kg
Number of Operations @ 0.7pf	200 x 630A	Switch NETT wt =	75 kg
Rated Short Time (1s)	I <sub>sk</sub> 16kA		

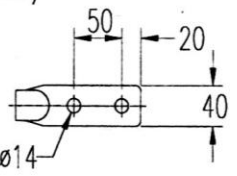

⑧ DETAIL OF TERMINALS

Issue	Change	Dat	Auth.
11	Bottom view revised.	08-04	
10	Updated	10-03	
9	Notes revised.	09-03	
8	Crossarm dims. added.	09-03	
7	Operation mode revised.	08-03	
6	583 was 580.	06-03	
5	Optional Lock Revised.	05-03	
4	Updated	03-03	
3	Optional Lock Added	03-03	
2	Updated	02-03	
1	Original	01-03	

This document is the property of NGK STANGER P/L and must not be copied or reproduced without written permission, nor disclosed to any third party.

 Quality Endorsed Company AS/NZS ISO 9001:2000 Licence Number 368 Standards Australia	12kV 630A SF6 LOADBREAK SWITCH MANUAL TYPE-HORIZONTAL MTG. with PORCELAIN BUSHINGS		 NGK STANGER Pty. Ltd. A.B.N. 89 004 225 012 MELBOURNE AUSTRALIA
	DRAWN (S) [Signature] CHECKED (S) [Signature]	APPD [Signature] DATE 22-01-2003	

PROJECTION	ORIGIN	SIZE	DRAWING No.
	G&H-A-12	A4	91776