

No.	DATE	REVISION	CHECK

METRIC DIMENSIONS UNLESS OTHERWISE NOTED

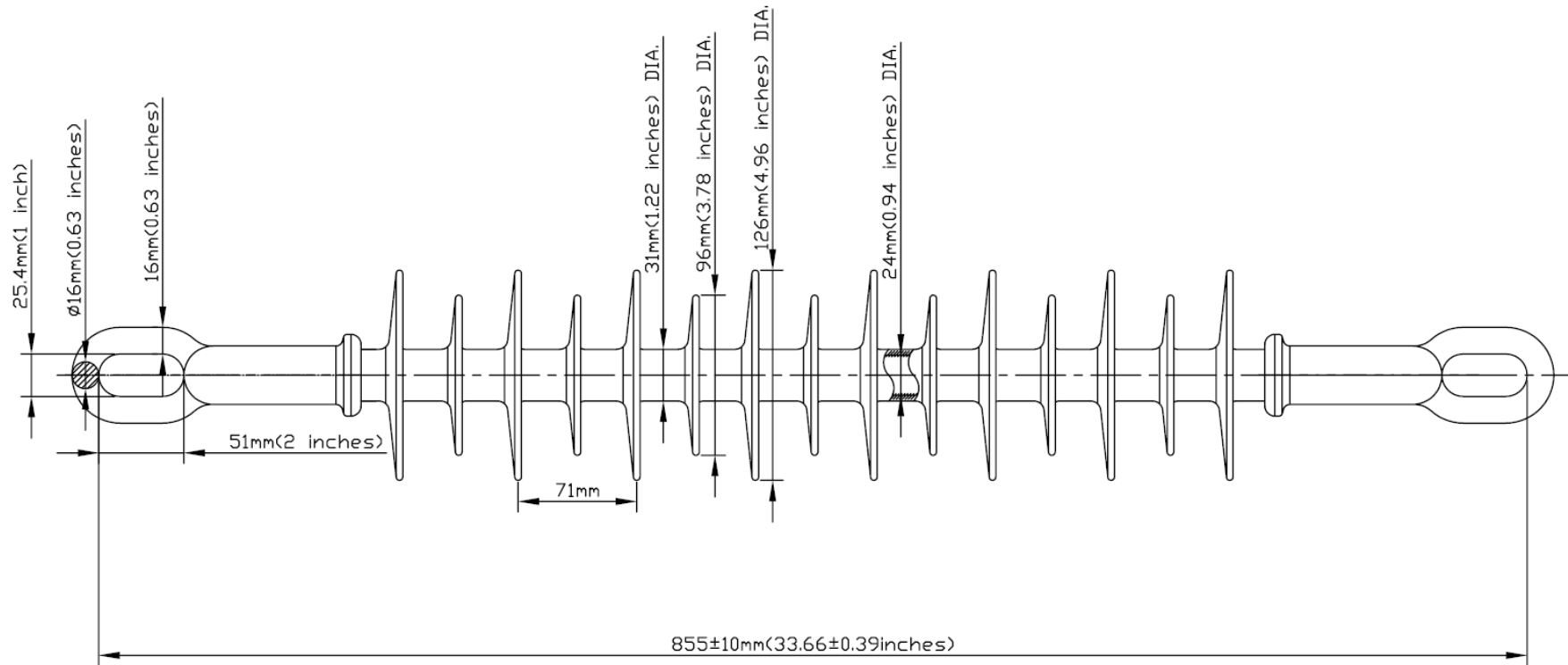

**REQUIREMENTS**

SECTION LENGTH	855±10mm(33.66±0.39 inches)
SPECIFIED MECHANICAL LOAD	160 kN
ROUTINE TEST LOAD RATING	80 kN
END FITTINGS DESIGN	OVAL-EYE & OVAL-EYE
SHEDS Q'TY	15 PCS
DRY ARCING DISTANCE	585mm(23.03 inches)
LEAKAGE DISTANCE	1,658mm(65.28 Inches)
60 Hz DRY FLASHOVER	263 kV
60 Hz WET FLASHOVER	228 kV
CRITICAL FLASHOVER(POS)	380 kV
CRITICAL FLASHOVER(NEG)	410 kV
LIGHTNING WITHSTAND(POS)	350 kV
LIGHTNING WITHSTAND(NEG)	375 kV
WEIGHT	4.6 kg(10.14lbs)
P1-P2	15 mm
S/P	1.49 (P1=47.5mm, P2=32.5mm, S=71mm, l=215.87mm)

**NOTE:**

1. END FITTINGS ARE MADE FROM CARBON STEEL CASTINGS AND GALVANIZED
2. FIBERGLASS ROD IS MADE FROM EPOXY RESIN.
3. THE DIA. OF FRP ROD IS 24mm(0.94Inches) SOLID.
4. THE THICKNESS OF HOT DIP GALVANIZING SHALL BE 90 μm(MIN. AVE)
5. HARDWARE ENDS TO BE STAMPED WITH JULIAN DATE, SML 160kN, SEHL015-B1100, TEST 60kN

DRAWN	DESIGN	CHECK	APPROVE	DATE
	C.H.PARK		S.Y.JUNG	
	JAN.10.2007		JAN.10.2007	SCALE /

PART	69kV SUSPENSION POLYMER INSULATOR OF TRANSMISSION LINES		
NAME	160kN POLYMER INSULATOR	DWG. NO.	SEHL015-B1100



**DTR CORPORATION**