

CODE No. LPFN-69SK-HP-M20

| NO. | DESCRIPTION | DWG. NO. | MATERIAL | Q'TY | FINISH/SIZE | NOTE |
|-----|-------------|----------|----------|------|-------------|------|
| | | | | | | |
| | | | | | | |
| | | | | | | |

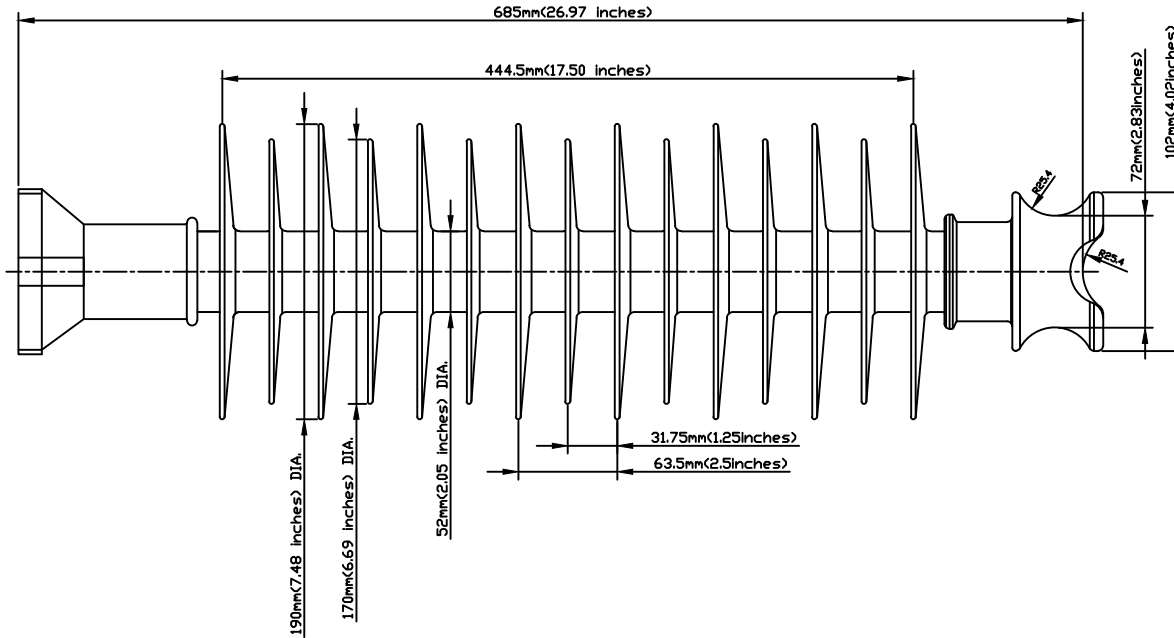
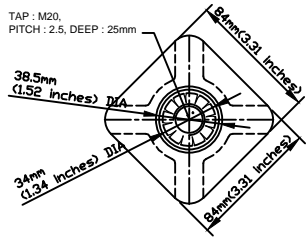

DIMENSIONS

| | |
|---------------------|----------|
| LEAKAGE DISTANCE | 2,330 mm |
| DRY ARCING DISTANCE | 560 mm |
| SHEDS Q'TY | 15 PCS |

MECHANICAL VALUES

| | |
|-----------------------------|---------|
| SPECIFIED CANTILEVER LOAD | 12.5 kN |
| Max. DESIGN CANTILEVER LOAD | 6 kN |
| TENSILE STRENGTH | 22 kN |

ELECTRICAL VALUES

| | |
|-------------------------|--------|
| Low-Freq. FLASHOVER-DRY | 230 kV |
| Low-Freq. FLASHOVER-WET | 200 kV |
| IMPULSE FLASHOVER-POS | 380 kV |
| IMPULSE FLASHOVER-NEG | 470 kV |
| Low-Freq. WITHSTAND-DRY | 180 kV |
| Low-Freq. WITHSTAND-WET | 160 kV |
| IMPULSE WITHSTAND-POS | 345 kV |
| IMPULSE WITHSTAND-NEG | 430 kV |

PACKING INFORMATION

| | |
|-------------------------|---------|
| NET WEIGHT EACH | 9.05 kg |
| NO. IN STANDARD PACKAGE | 1 PCS |

NOTE:

1. TOP END FITTING IS MADE FROM ALUMINUM ALLOY.
2. BASE END FITTING IS MADE FROM CARBON STEEL FORGED & GALVANIZED.
3. FIBERGLASS ROD IS MADE FROM EPOXY RESIN.
4. STUD BASE DIMENSIONS ARE IN ACCORDANCE WITH ANSI C29.18
5. THE DIA. OF FRP ROD IS 45mm(1.77inches) SOLID.
6. BASE AND INSULATOR ASSEMBLED WITH M20 BOLT AND WASHER.
7. THE TOLERANCE ON ALL DIMENSIONS SHALL BE AS FOLLOWS:
 $\pm(0.04d+1.5)$ mm when $d < 300$ mm
 $\pm(0.025d+6)$ mm when $d > 300$ mm with a maximum of 50mm

| NO. | DATE | REVISIONS | DESIGNED | APPROVED | REMARKS | DRAWN BY | DESIGNED BY | CHECKED BY | APPROVED BY | SCALE | DATE | NAME | SHEET NO | |
|-----|------------|-----------------|----------|----------|---------|----------|-------------|------------|-------------|-------|------|---------|---|------------------|
| 1/R | 02/09/2017 | INITIAL RELEASE | J.H.PARK | C.H.PARK | | J.H.PARK | | | C.H.PARK | 1/1 | | | Polymer Line Post Insulator for Distribution 69kV HP F-NECK LP Insulator | REF.NO. |
| | | | | | | | | | | | | DWG.NO. | | LPFN-69SK-HP-M20 |

