

Efen NH-La-Lei 1N B6 250A Vertical 1P Switching Switch

NZI Part No: 531839
Efen Part No: 38612.0000
Threaded Bolt M12x30

HQ & FACTORY
THOMAS STREET
PO BOX 5 TEMUKA 7948
T +64 3 615 0085

AUCKLAND SALES OFFICE
2/40 ARRENWAY DRIVE
ROSEDALE 0651
T +64 9 479 4794



Terminal	Dimension a
Inserted screw nut	180
V-stamped	140

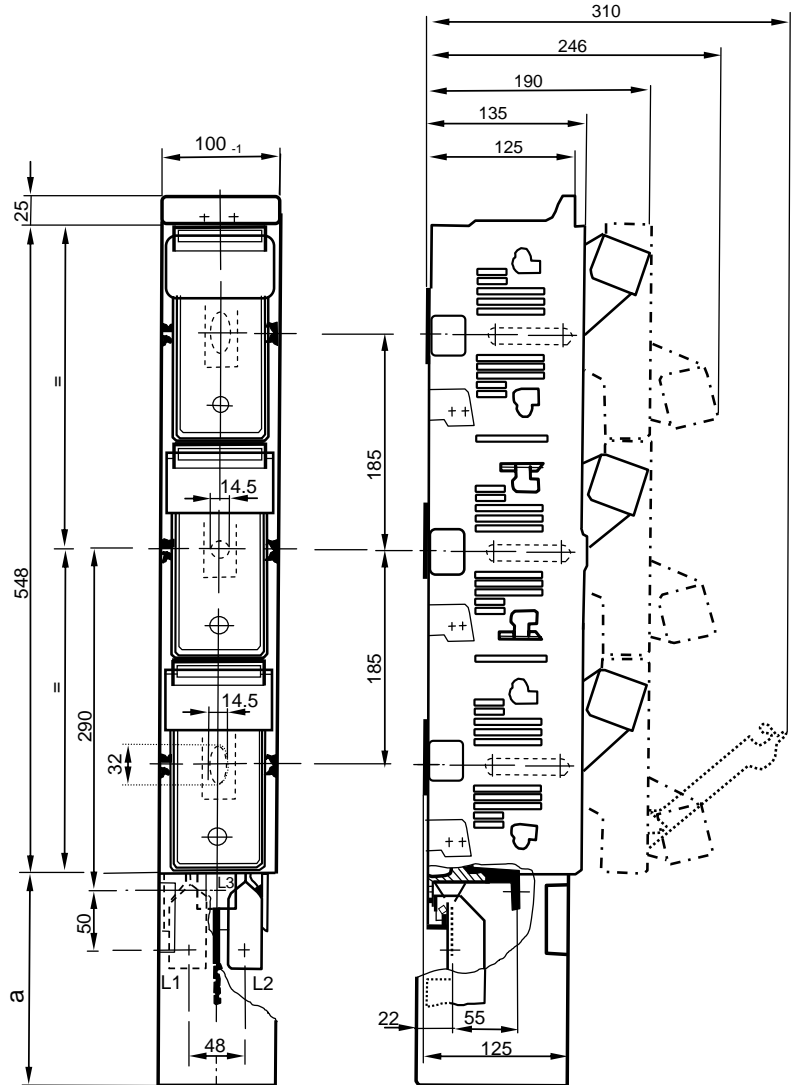

For LV fuse links acc. to DIN 43620/1 ¹	Size	00	1	2	3	4a	³ 1000 A ³)
Rated operational current I _e	A	160	250	400	630	1250/ 1600 ²	1000
Conventional free air thermal current I _{th}	A	160	250	400	630	1250/ 1600 ²	1000
Rated operational voltage U _e Rated insulation voltage U _i	V	690	690	690	690	690	690
Rated impulse withstand voltage	kV	8	8	8	8	8	8
Rated conditional short circuit current (When protected by fuse links)	kA	20	50	50	50	50	-
Utilisation category IEC 947-3	U _e = 400 V U _e = 690 V U _e = 440 V	AC-22B AC-21B DC-21B	AC-22B AC-21B DC-21B	AC-22B AC-21B DC-21B	AC-22B AC-21B DC-21B	AC-22B AC-21B DC-21B	AC-22B AC-20B DC-20B
Mechanical Durability	Cycles	1000	1000	1000	1000	1000	1000
Permissible ambient air temperature	°C	-25 up to +55					

¹ When using gR-Fuse-Links (VDE 0636/23), please ask for information
² Isolator unit with solid copper-links only (on demand).