

ALL DIMENSIONS IN MILLIMETRES - DO NOT SCALE - IF IN DOUBT PLEASE ASK

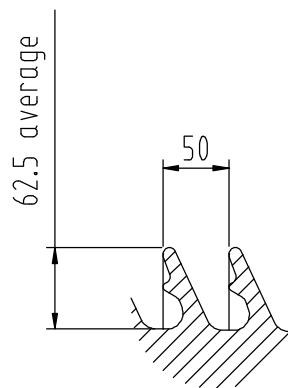
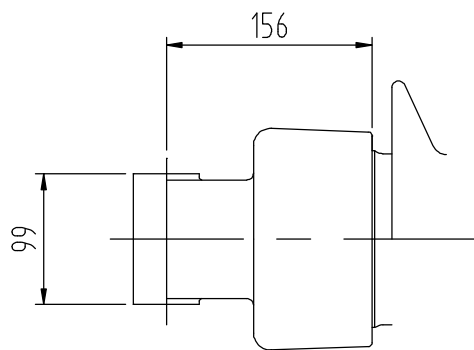
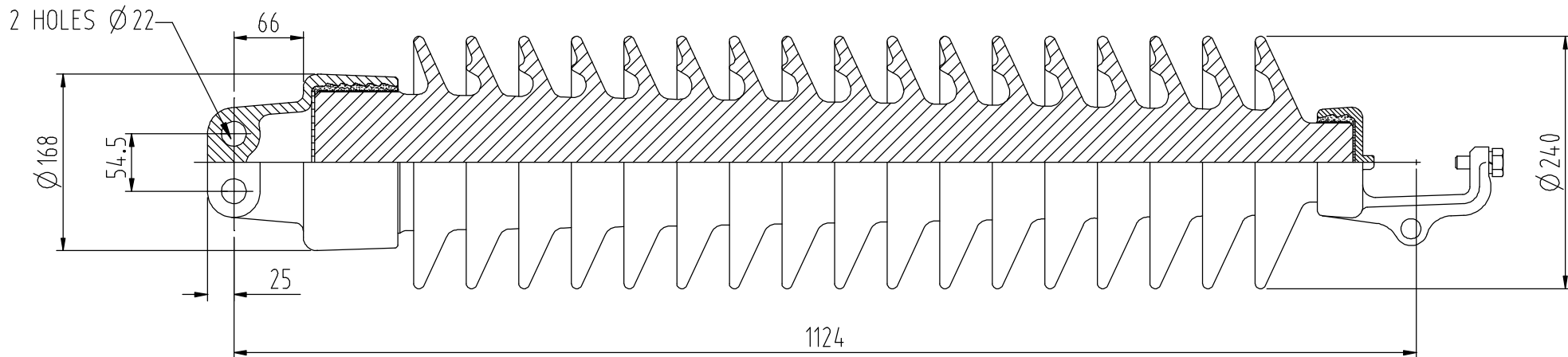

Technical Specification

| | DESIGNED VALUES |
|--------------------------------|-----------------|
| <u>SYSTEM HIGHEST VOLTAGE</u> | 110 kV |
| <u>WITHSTAND TEST VOLTAGES</u> | |
| a. Power frequency – wet | > 250 kV |
| b. Lightning impulse – dry | 600 kV |
| <u>MINIMUM FAILING LOADS</u> | |
| a. Cantilever | 10 kN |
| b. Torsion | 600 Nm |
| c. Tension | 22 kN |
| <u>CREEPAGE DISTANCES</u> | |
| a. Total | 2850 mm |
| b. Protected | 1315 mm |
| c. Flashover | 930 mm |

Pollution Performance N* (ESAA Publication D (b) 19-1975) = 12.9

| Issue Mod. No. | Date |
|----------------|--------------|
| H | 3493 15.1.13 |
| G | 3068 11.7.03 |
| F | 2991 3.9.02 |
| E | 2989 23.8.02 |
| D | 2987 21.8.02 |
| C | 2973 18.7.02 |

Drawn J. Bain
Date 19.12.2001



NEW ZEALAND INSULATORS **nzi** TEMUKA

NEW ZEALAND INSULATORS LTD
Tel: +64-3-687 8100
Fax: +64-3-615 8125
e-mail: sales@nzinsulators.co.nz

110kV HORIZONTAL C/T L/POST
Class 3 CREEPAGE WITH SPECIAL BASE

D725-0524/H